

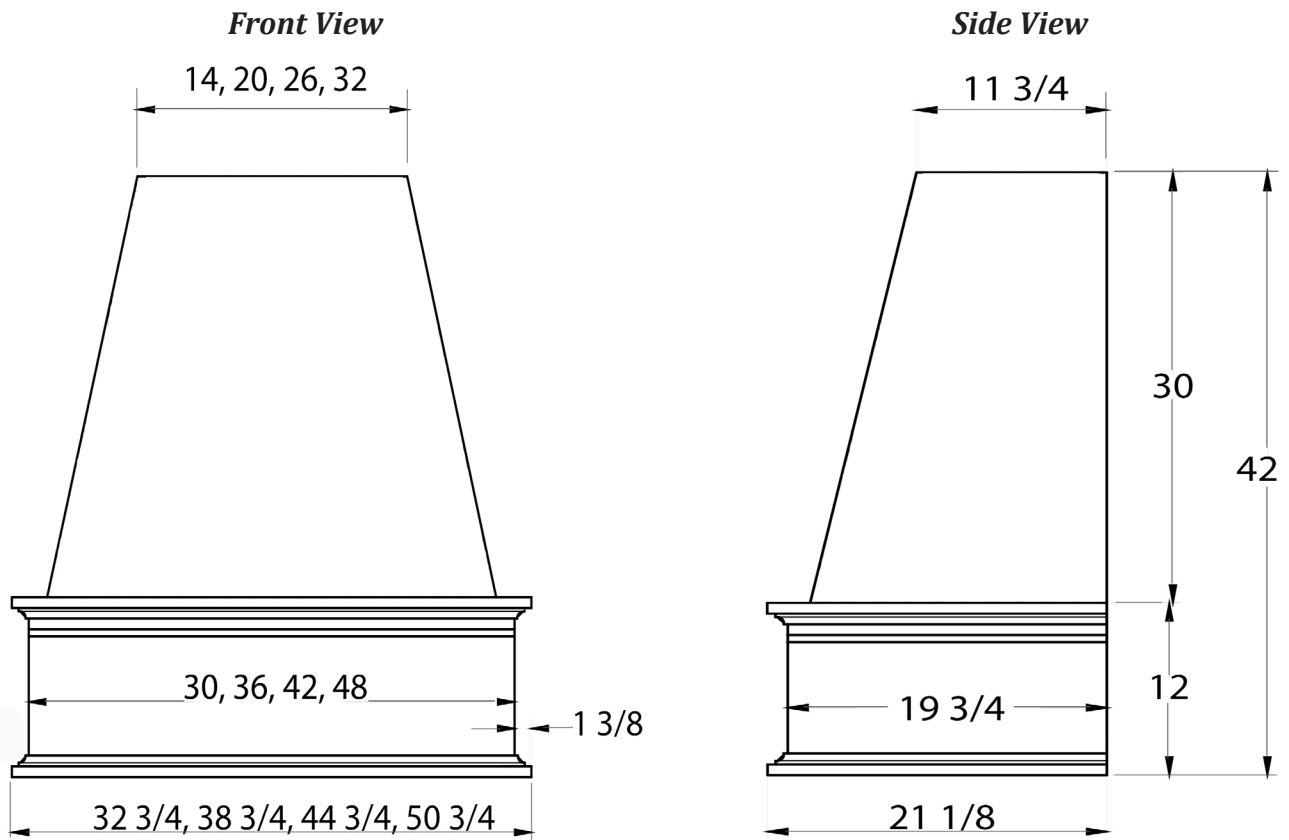

Tall Traditional Chimney Hood

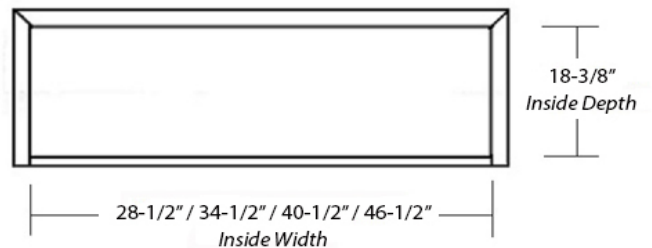

Item #	Dimensions (h) x (w) x (d)	Liner	Liner
SY-WCHH-30	42" X 32-3/4" X 21-1/8"	SY-HLB-30	SY-HLZ-30
SY-WCHH-36	42" X 38-3/4" X 21-1/8"	SY-HLB-36	SY-HLZ-36
SY-WCHH-42	42" X 44-3/4" X 21-1/8"	SY-HLB-42	SY-HLZ-42
SY-WCHH-48	42" X 50-3/4" X 21-1/8"	SY-HLB-48	SY-HLZ-48



- Hardwood Plywood and Solid Lumber Construction
- 1/2" Rear Plywood Stretchers for wall mounting
- Accepts SY-HLB series Powder Coated or Stainless Steel Liners (sold separately)
- Select from 300, 400, and 600 CFM Broan Ventilation power packs (sold separately) or
- Ascension 350SL, 350SS, 500SS and 620SS CFM Ventilation power packs (sold separately) or
- 30" and 36" models accept Ascension 900 CFM Professional Ventilators (requires HLZ series Liners)
- 42" and 48" models accept Ascension 1200 CFM Professional Ventilators (requires HLZ series Liners)
- Available in Alder, Cherry, Hickory, Maple, Red Oak, and White Oak
- Optional Detachable Upper Access available
- Optional 15", 24", and 36" height Chimney Extensions available
- Base section will accommodate Ornaments in sizes up to 6" x 24"

